



## **SES America premieres options in Mobility series setting new industry standards in sign efficiency, flexibility, and design**



**In Pittsburgh on June 1st, SES America demonstrated new LED technologies and DMS options** which were warmly recieved to a large crowd of decision makers, for their innovation, practicality, and efficiency.

The mobility series unique **multiphase capabilities allow for multiple messages without the cost and maintenance of larger DMS messaging signs.** The Mobility series can be operated remotely via an Internet device, via vehicle activation, or with a state of the art controller. Equipped for NTCIP compliancy, the SES America custom approach to messaging technology product development stands alone in the ITS industry. **SES has already delivered hundreds of mobility signs in just a few short months. Take a minute to [reach out](#) to us on your next project to evaluate how SES America might save money and time, both short and long term.** Rural or urban, whatever the [application](#), we have a viable solution. Telephone SES America

at 401.232.3370 401.232.3370 for immediate response and feedback to your questions.

## DMS CONNECT

### -SESA dynamic messaging takes to the cloud!-

SES America latest new technology, **DMS CONNECT**, utilizes [cloud data](#) sources for accurate travel time reports, was **recently highlighted in a current edition of [ITS International](#)**. This new ITS industry technology **offers reliable, affordable, and up to the minute traffic information on any size DMS, anytime, anywhere!**

Whether optimized with self sufficient solar power on a remote Arizona highway or on a heavily urbanized New Jersey street, both states have more than a current passing interest in

this **simple, yet effective tool enhancing the travel experience and improving state ITS capabilities on restrictive budgets while remaining eligible for FHWA funding.**

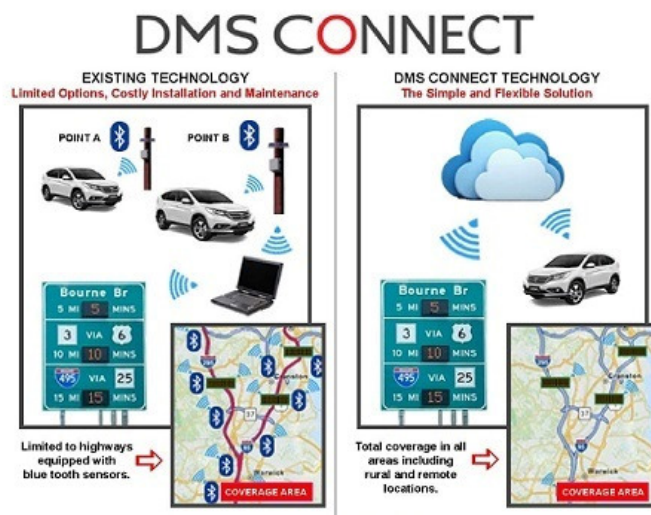

### -Connect DMS direct for fast, accurate, travel time!-

- *No [software needed](#). Very low or no maintenance*
- *Update travel time every minute, automatically*
- *Eliminate roadside vehicle detection i.e. bluetooth*

- *Pick any latitude and longitude destination time*
- *Affordable with options for use-on-demand*
- *Ideal for rural and arterial applications*
- *With SolarSign, a complete solution with a high rate of return on investment*

We can share this exciting new solution via a [webinar](#), in a [lunch](#) and learn format, simply sharing a thumbnail of the highlights of **DMS CONNECT** over the phone. Give us a [call or email](#). We would be thrilled to set a time at your convenience.

---

— Latest SESA News—

### **Manufacturing News, Summer 2015**



MUTCD compliant multiphase mobility

**With summer in full swing**, major construction projects are underway. Here is a **quick list of types of ITS signs shipped** in either the last 30 days or soon to leave the SESA America facility in the coming days.

---

---

**placement.**

- **Full matrix DMS signs, bridge mounted, in a heavy salt water environment**
- **Mobility signs for truck / no truck access**
- **Color full matrix airport gateway entry sign, Walk in**
- **Retrofit upgrade kits to three major states for prime urban deployment**
- **Rural deployed DMS signs in Arctic Circle conditions**
- **Solar powered travel time project**



[inShare](#)